

N20-808-16

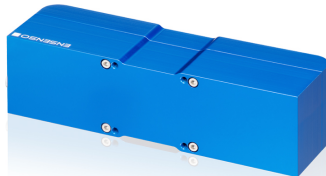

Specification

Technical data

Minimum working distance	280 mm
Maximum working distance	360 mm
Optimum working distance	310 mm
Focal length	8 mm
Mass	550 g
Vergence angle	8.00
Resolution (h x v)	1280 x 1024
Dimensions H/W/L	50.0 mm x 175.0 mm x 50.0 mm
f-number	1.6
Base line	100 mm
Power consumption	9.5 W

Measurement volume

Distance	Z resolution	View field size X	View field size Y	Optics blur	Pixel size
272 mm	0.062 mm	206.56 mm	186.20 mm	2.462 px	0.182 mm
275 mm	0.063 mm	209.95 mm	188.26 mm	2.309 px	0.184 mm
280 mm	0.066 mm	215.58 mm	191.68 mm	2.060 px	0.187 mm
285 mm	0.068 mm	221.22 mm	195.10 mm	1.820 px	0.191 mm
290 mm	0.070 mm	226.85 mm	198.52 mm	1.588 px	0.194 mm
295 mm	0.073 mm	232.49 mm	201.95 mm	1.363 px	0.197 mm
300 mm	0.075 mm	238.12 mm	205.37 mm	1.145 px	0.201 mm
305 mm	0.078 mm	243.76 mm	208.79 mm	0.934 px	0.204 mm
310 mm	0.080 mm	249.39 mm	212.21 mm	0.730 px	0.207 mm
315 mm	0.083 mm	255.03 mm	215.64 mm	0.901 px	0.211 mm
320 mm	0.086 mm	260.39 mm	219.06 mm	1.079 px	0.214 mm
325 mm	0.088 mm	264.46 mm	222.48 mm	1.246 px	0.217 mm
330 mm	0.091 mm	268.53 mm	225.91 mm	1.407 px	0.221 mm
335 mm	0.094 mm	272.59 mm	229.33 mm	1.565 px	0.224 mm
340 mm	0.097 mm	276.66 mm	232.75 mm	1.718 px	0.227 mm
345 mm	0.100 mm	280.73 mm	236.17 mm	1.866 px	0.231 mm
350 mm	0.102 mm	284.80 mm	239.60 mm	2.011 px	0.234 mm
355 mm	0.105 mm	288.87 mm	243.02 mm	2.151 px	0.237 mm
360 mm	0.108 mm	292.94 mm	246.44 mm	2.288 px	0.241 mm

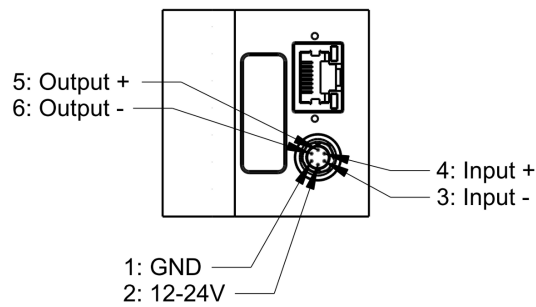
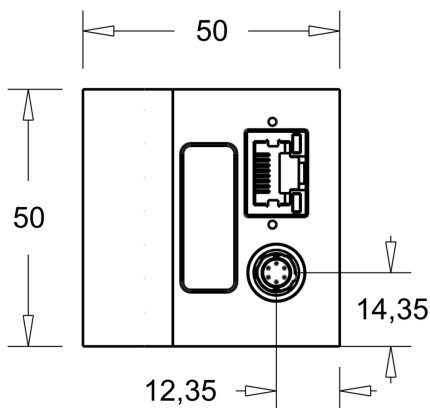
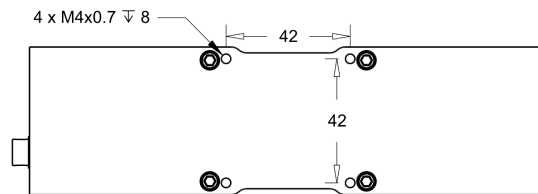
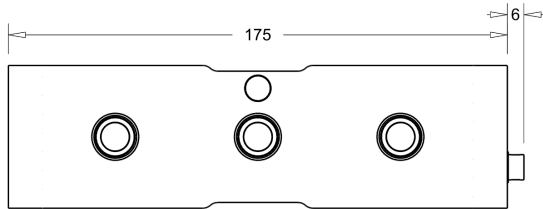

Subject to technical modifications

N20-808-16

