

N20-1202-16

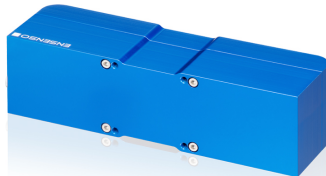

Specification

Technical data

Minimum working distance	1100 mm
Maximum working distance	2200 mm
Optimum working distance	1400 mm
Focal length	12 mm
Mass	550 g
Vergence angle	2.00
Resolution (h x v)	1280 x 1024
Dimensions H/W/L	50.0 mm x 175.0 mm x 50.0 mm
f-number	1.6
Base line	100 mm
Power consumption	9.5 W

N20-1202-16

Measurement volume

Distance	Z resolution	View field size X	View field size Y	Optics blur	Pixel size
1100 mm	0.640 mm	543.64 mm	476.31 mm	1.736 px	0.465 mm
1150 mm	0.700 mm	572.90 mm	497.96 mm	1.396 px	0.486 mm
1200 mm	0.762 mm	602.15 mm	519.61 mm	1.084 px	0.507 mm
1250 mm	0.827 mm	631.41 mm	541.26 mm	0.797 px	0.529 mm
1300 mm	0.894 mm	660.67 mm	562.91 mm	0.531 px	0.550 mm
1350 mm	0.964 mm	689.92 mm	584.56 mm	0.286 px	0.571 mm
1400 mm	1.037 mm	719.18 mm	606.21 mm	0.058 px	0.592 mm
1450 mm	1.112 mm	746.31 mm	627.86 mm	0.266 px	0.613 mm
1500 mm	1.190 mm	772.05 mm	649.51 mm	0.460 px	0.634 mm
1550 mm	1.271 mm	797.78 mm	671.16 mm	0.642 px	0.656 mm
1600 mm	1.354 mm	823.52 mm	692.81 mm	0.813 px	0.677 mm
1650 mm	1.440 mm	849.25 mm	714.46 mm	0.973 px	0.698 mm
1700 mm	1.529 mm	874.99 mm	736.11 mm	1.124 px	0.719 mm
1750 mm	1.620 mm	900.72 mm	757.76 mm	1.266 px	0.740 mm
1800 mm	1.714 mm	926.46 mm	779.41 mm	1.401 px	0.761 mm
1850 mm	1.811 mm	952.19 mm	801.06 mm	1.528 px	0.782 mm
1900 mm	1.910 mm	977.93 mm	822.71 mm	1.648 px	0.804 mm
1950 mm	2.012 mm	1003.66 mm	844.36 mm	1.763 px	0.825 mm
2000 mm	2.116 mm	1029.40 mm	866.01 mm	1.871 px	0.846 mm

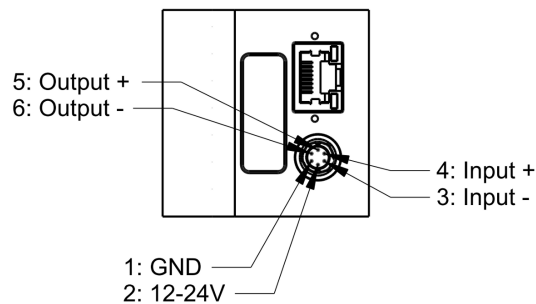
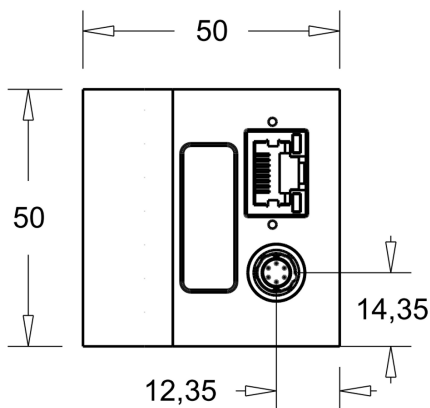
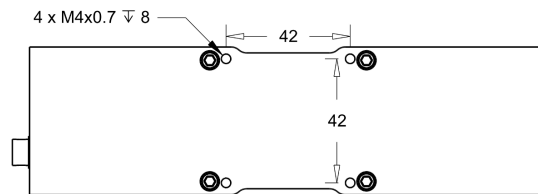
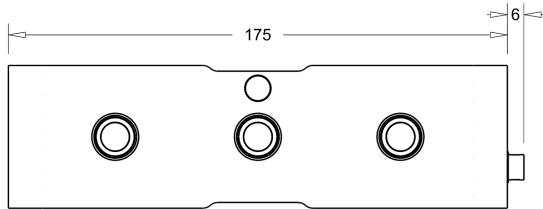

Subject to technical modifications

N20-1202-16

